

INSTALLATION GUIDE

PWTIMFRSTOP 60-Minute Fire-Rated
Party Wall Cavity Stop Sock Timber-Masonry

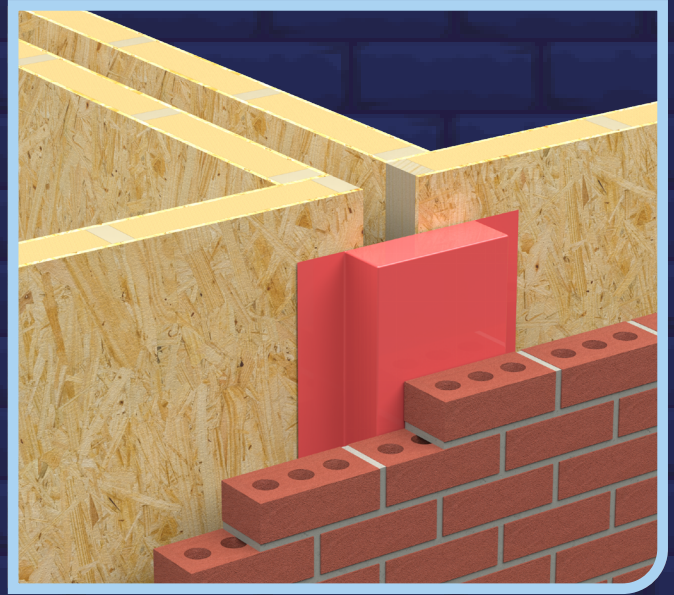

60-minute fire-rated
3rd party tested by
Warringtonfire



Approved
Document B
compliant



Robust
Detail Part E
compliant



Satisfies
NHBC technical
requirements



Mineral wool
BS EN 13162
compliant

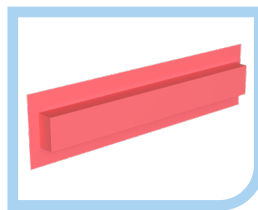

PWTIMFRSTOP50-150

PWTIMFRSTOP can be installed via one of two methods:

Direct fix via polythene flanges to the timber frame:

1.

Secure each length of PWTIMFRSTOP to the timber frame through the polythene flanges with clout nails or staples spaced 150mm apart.

2.

To install in the vertical direction apply nails or staples to the flanges on both sides of the product.

3.

To install in the horizontal direction apply nails or staples to the flange on the top edge of the product only.

4.

The construction of the outer leaf can then be completed, ensuring that the cavity width is correct and maintains compression to the PWTIMFRSTOP lengths.

Compression fit between the inner and outer leaf as brick courses progress upwards:

1.

Build up the inner and outer leaf to the level at which the PWTIMFRSTOP will be situated.

2.

Check that the cavity width is correct to specification and will provide a compression fit onto the PWTIMFRSTOP lengths.

3.

Ensure that the mortar of the brick work is set then insert the PWTIMFRSTOP lengths into the cavity between the inner and outer leaf.

General installation notes:



Scan or click to view product datasheet

- Ensure that the PWTIMFRSTOP lengths fully fill the cavity with an even amount of compression on both sides.
- At junctions the lengths of PWTIMFRSTOP should be cut to the appropriate length and butt jointed firmly to the next length or to the supporting construction.
- When trimming the lengths any excess polythene should also be trimmed and folded back over to maintain the site weather protection.
- Do not bend or deform the lengths to fit into the cavity around corners or junctions as this will damage the mineral wool insulation.
- The polythene outer layer does not contribute to the fire rating of the PWTIMFRSTOP it is only used to aid the installation via the flanges and provide site weather protection. If the polythene becomes pierced or torn the stop sock will still function as intended.
- If the mineral wool insulation in one of the PWTIMFRSTOP lengths is broken or damaged before installation then it should be discarded and replaced with another undamaged length.
- When installed horizontally a preformed horizontal cavity tray should be incorporated into the cavity wall construction (refer to technical department for the appropriate type to suit) and proprietary wall weep vents (1143) spaced at 900mm centres to prevent water ingress from bridging the cavity.