

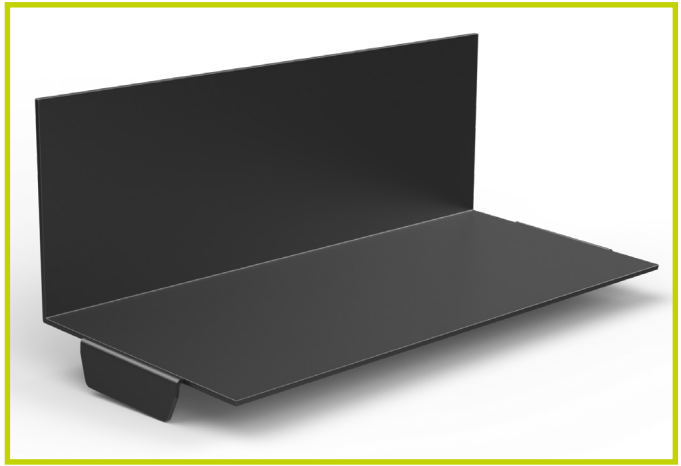

Ambi-Soaker - Interlocking Plain

Ambi-Soaker Universal Dry Fix Abutment Soaker for Interlocking Plain Tiles



Uses

- Interlocking Plain Tiles
- Abutments between a pitched roof and a wall
- New build or refurbishment projects

Features and Benefits

- Pre-formed product shape saves cost and labour time compared to site-fabricated soakers
- Patent Pending design provides a universal product with fixing tabs for both LH or RH Installations
- Fixing tabs can be trimmed away as required
- Sits underneath abutment flashing material. Compatible with stepped or continuous flashings
- Protects roof abutment areas from rain and weather
- Long lasting, reliable and virtually maintenance free
- Lightweight product allows easy handling and installation
- Simple and clean mortar-free installation process
- Helps to minimise contamination of water course compared to lead soakers
- Reduced lead usage within the build helping to deter theft
- Resistant to UV light and acid rain

Quality

- Manufactured to BS EN ISO 9001 and BS EN ISO14001
- Complies with all relevant sections of the Building Regulations
- Satisfies all relevant NHBC requirements

Compatibility

Most Interlocking Plain tiles from major manufacturers including:

- Marley Ashmore
- Redland Duoplain
- Forticrete Gemini

Material and Colour Choice

- UV protected and colour-fast Polypropylene
- Available in Black only

Installation Advice

- Please refer to www.timloc.co.uk for recommended installation guidance.

How to Order

- Ambi-Soakers are fitted one unit per tile for the entire length of the abutment. Check the pack quantity against the number of tiles in the run to ensure you have enough Ambi-Soaker units.

Product Codes

Description	Colour	Pack Quantity	Product Code
Ambi-Soaker for Interlocking Plain Tiles	Black	40	AS-INTPLAIN

Product Dimensions

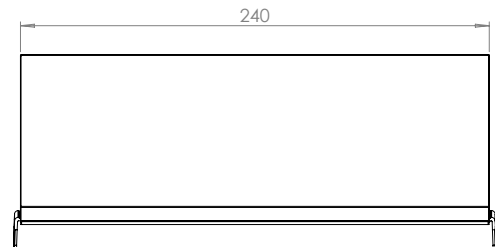

Front Profile

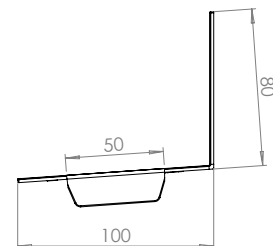

Side Profile