

Please read these instructions carefully before starting work. For any clarifications contact the Timloc Technical department.

Cavity trays must always be bedded onto fresh mortar, never dry bedded.

The masonry which is then laid over the cavity trays must also be bedded onto fresh mortar with the result that the base of the cavity tray is positioned approximately half way through the mortar joint.

General impression

of how a complete cavity tray system should be set out:

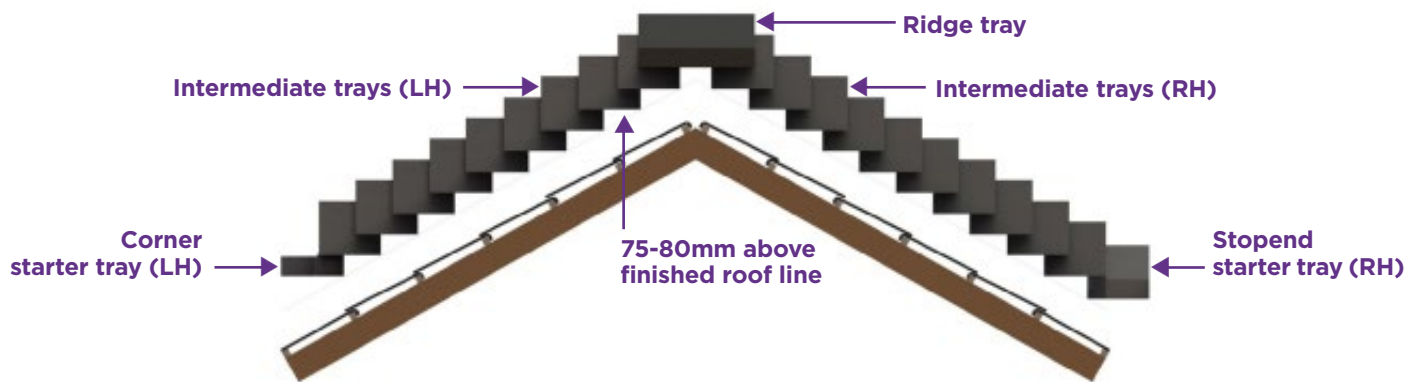

Lead Flashings

In most cases, a cavity tray will be required to work in conjunction with a lead flashing at a roof/wall abutment. The cavity tray protects the inside of the outer leaf and the cavity and the lead flashing protects the face of the outer leaf and the junction between the roof covering and the wall.

The lead flashings associated with cavity trays can be dealt with in one of two ways. Either as a factory-fitted integral part of the cavity tray or as an independent flashing fitted separately to the cavity tray. When specifying or installing cavity trays and lead flashings it is important to consider the following recommendations:

- In the case of stepped cavity trays it is very important to specify the exact pitch of the roof. The lead flashings are accurately cut to suit the specified pitch and will look aesthetically incorrect if used on any other roof pitch
- All leaded cavity trays are available with a choice of 'long' or 'short' leads and it is important to specify which is preferred. The general rule is that long leads are used where the flashing is required to dress down over the surface of the roof covering and short leads are used in conjunction with a separate soaker or secret gutter detail. It is important to remember that this is just a general rule and many specifiers and end users have their own preferences as to how the flashings should be dressed. Timloc must be informed of any specific requirements.

Short Leads

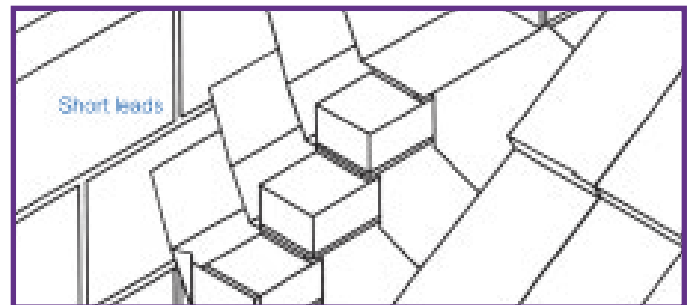

Long Leads

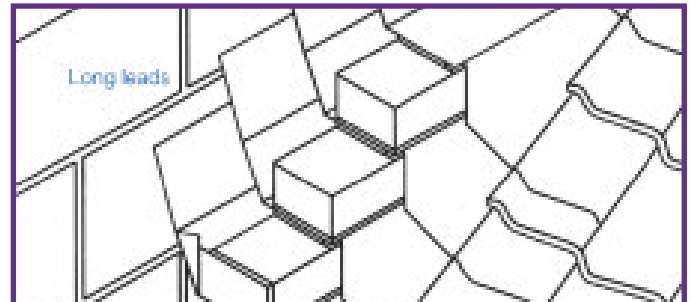

Product Selection

Timloc recommend that customers take advantage of our Technical service which is freely available to all users and specifiers of Timloc products. The Technical department will be pleased to advise on the most suitable products to meet the application and can also prepare a fully itemised schedule of quantities.

Please provide as much information as possible, including drawings if they are available. All enquiries should include the following information as a minimum requirement:

- The materials used for construction of the outer leaf, i.e. brick, block or stone, including the bed thickness and course height
- The overall structural cavity width within the wall
- The type and thickness of any insulation material used within the wall cavity
- The pitch of the roof (in the case of pitched roof abutments)
- The type of roof covering or state whether long or short leads are required (in the case of leaded cavity trays)
- Clear dimensional information or accurate scale drawings relevant to the areas requiring cavity trays
- Comments with regard to the weather exposure of the site
- Any specific or non-standard requirements are to be clearly stated

Measurement Areas

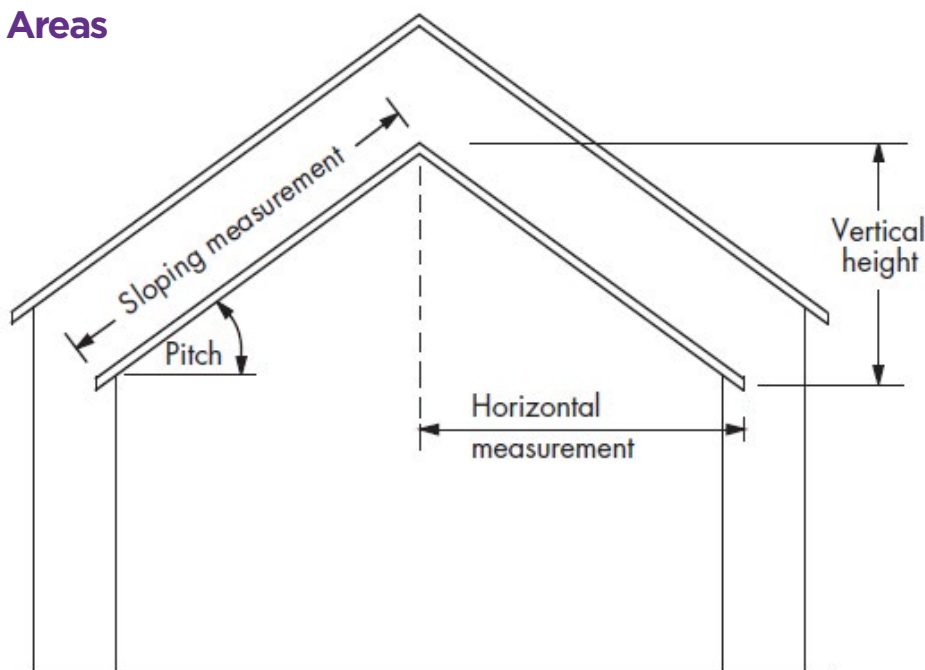

Cavity Tray Scheduling

Timloc Building Products offer a free scheduling/estimating service for our full range of products, we primarily and most frequently schedule for cavity trays as there are numerous variations of products to suit specific applications.

Our schedule format can be produced to your individual instruction i.e. specific to site, house types, blocks, plots and even area of application to give a comprehensive and accurate schedule.



Technical | Kerry Taylor

Technical Service Manager

T: 01405 782 769

E: technical@timloc.co.uk

If you require further information, clarification, or to enquire about our call-off and scheduling service please get in touch with the Timloc Building Products Technical Department and we will be happy to assist.

Product datasheets are also available at: www.timloc.co.uk