

INSTALLATION GUIDE

Recessed Radiator Pipe Guide and Seal



Manufactured to BS EN ISO 9001
and BS EN ISO 14001



Helps to meet: Building Regulation Document Part L - Conservation
of Fuel and Power

To install Rad-Seal you will need:

- 1x hole saw (86,90 or 100mm diameter) or a standard saw suitable for cutting into plasterboard
- 1 x pencil for marking up
- 1 x Pozidrive screw driver
- 3 x metal screws (no more than 4mm Pozidrive and Countersunk)
- 3 x wall plugs suitable for plasterboard and medium weight use

1.

Suitable for:

Installation within all wall constructions that present a concealed pipe void including:

- Studded dry lined walls
- Plaster dab slab solid walls

The unit will accept routed pipework from:

- a. Below (ground floor).
- b. Horizontally (ie. under window) NB. Pipes from the sides must be crossed over for exit via the holes in the Rad-Seal.
- c. Above (upper floor).

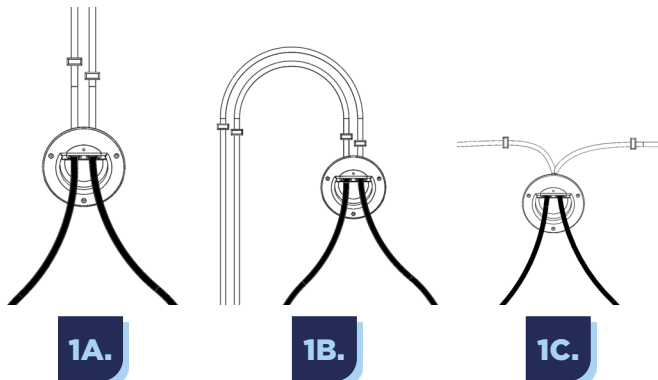

IMPORTANT NOTE: NOT SUITABLE FOR INSTALLATION WITH ELECTRICAL BACK BOX

Rad-Seal for 10mm pipework (1115)



Front



Back



Scan or click to view product
datasheet

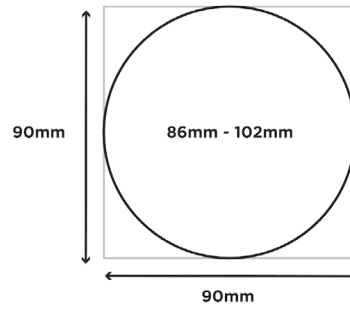
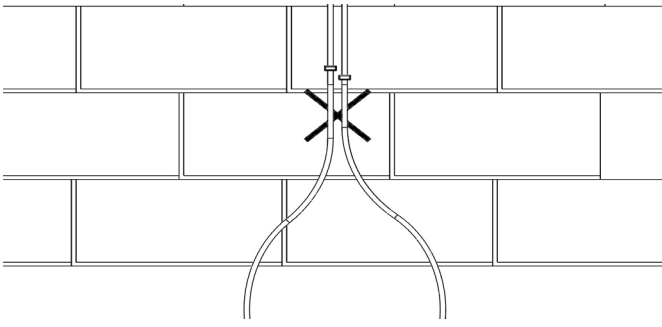

2.

Positioning unit:

- a. Clearly mark the centre of the proposed exit hole for the radiator pipework with a cross 'X' on the wall:
 - Approximately 350mm above the floor
 - Central to the final radiator position
- b. Secure the pipework in place with pipe clips approximately 50mm above the marked 'X'.

Note: Consider the radiator style and size for any fitting height variation that may be required. Allow clearance for the radiator wall fixing brackets.

3.

Preparing Pipework Entry Hole:

- a. Cut a round hole (86mm - 102mm diameter) into the plasterboard or a 90mm x 90mm square plaster hole, ensuring that the midpoint of the marked 'X' is in the centre of the hole.
- b. Feed and secure the radiator pipework loop through the hole.
- c. The unit can be fixed at a later stage; therefore the plasterboard can be fixed and plastered as normal.

IMPORTANT: KEEP THE HOLE CLEAR AND CLEAN FROM PLASTER.

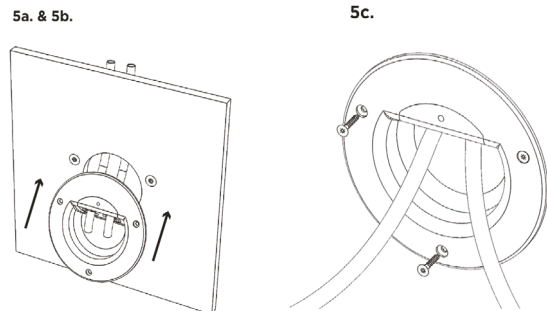
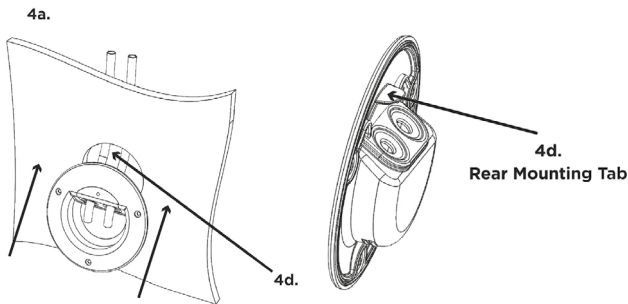

4.

Preparing screw fixing points:

- a. Position the unit over the hole to enable pipework entry i.e. gasket seal holes facing down.
- b. Cut the radiator pipework loop at the midpoint into two equal lengths.
- c. Feed the two pipework lengths through the back of the unit via the pipe entry gasket seal holes.
- d. Locate the rear mounting tab (on the reverse of the unit) and position it in line with the midpoint of the top of the plasterboard hole and push the unit into the hole.
- e. With the unit in place, clearly mark the three screw hole locations onto the plasterboard.
- f. Withdraw the unit from the wall to allow access for fixing the three wall plugs.

5.

Permanent fixing:

- a. Feed the unit back onto the pipework and offer the unit into the hole as before.
- b. Line up the unit's fixing holes to the wall plug holes and push the unit securely into the hole.
- c. Fix the three screws into the wall plugs.
- d. Loop the pipework to the radiator valves and connect in accordance with the radiator manufacturer's guidance.pipes when fixing wall plugs and screws.

e. IMPORTANT: DECORATORS CAULK OR ANOTHER SUITABLE SEALANT MAY BE REQUIRED ON UNEVEN WALL SURFACES AROUND THE PERIMETER OF THE UNIT PRIOR TO FINAL FIXING.