

# System 2000 Horizontal Cavity Trays

Horizontal cavity tray system for all types of brick, block and stone **new build constructions**

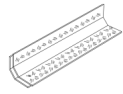

Horizontal cavity tray

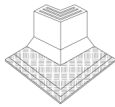

External corner



Internal corner tray

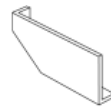

Stopend (LH)

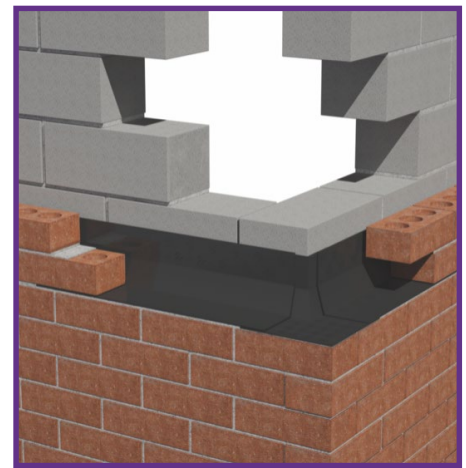

## Use

- At the abutment of a flat roof with a cavity wall
- At the abutment of a lean-to or mono pitch roof with a cavity wall
- Over concrete ring beams
- Over airbricks, cavity liners, ducts, meter boxes, etc.
- Clear cavity widths of between 50mm-150mm

## Features and Benefits

- 150mm high back upstand exceeds minimum requirements
- Low profile lapped joint between sections allows any length of brick, block or stone to be used without difficulty
- Angled section between cavity tray base and rear upstand automatically sheds water to the outer leaf
- Cavity tray builds into the outer leaf only to speed up installation to allow both inner and outer leaves to be built independently if required
- Choice of two lengths: 880mm for general use; 460mm to reduce waste when making up a run of cavity tray to the required length
- System available on request with pre-applied polystyrene strips.
- Polystyrene offers a visual locator of the cavity tray so aiding the installation of post fitted lead work. (May incur additional charge)

## Quality

- Satisfies all NHBC requirements
- Manufactured to BS EN ISO 9001 and BS EN ISO 14001
- Complies with all relevant Building Regulations
- Meets all relevant British Standards

## Material and Colour Choice

- All products are vacuum formed in 2.0mm thick rigid polyethylene - virtually indestructible in normal use
- Available in black only

## Products in the Range

### Horizontal cavity trays

The main cavity tray component. Sections join together by means of a lapped joint, sealed with factory applied butyl mastic tape, to form the main cavity tray run. Water is gathered by the cavity tray and is discharged from the wall through a series of weep holes.

### Corner units

Allows the integrity of the main cavity tray run to be maintained when it is necessary to turn a corner on a building. External or internal.

### Stopends

Fitted at the start and finish of the cavity tray run to seal off the open ends and prevent water running back into the cavity.

## Product codes

### System 2000 horizontal cavity trays (new build)

Description	Length	To suit cavity widths of:			
		50-74mm	75-99mm	100-124mm	125-150mm
Horizontal tray	880/830mm	2075/880/50	2075/880/75	2075/880/100	2075/880/150
Horizontal tray	460/410mm	2075/460/50	2075/460/75	2075/460/100	2075/460/150
External 90° corner	N/A	2010/50	2010/75	2010/100	2010/150
Internal 90° corner	N/A	2011/50	2011/75	2011/100	2011/150
External 135° corner	N/A	2012/50	2012/75	2012/100	2012/150
Internal 135° corner	N/A	2013/50	2013/75	2013/100	2013/150
Stopend RH	N/A	2003/50	2003/75	2003/100	2003/150
Stopend LH	N/A	2004/50	2004/75	2004/100	2004/150

## Installation advice

- Weep holes (1143 or Invisiweep) must be provided every 900mm along the cavity tray run to comply with Building Reg. requirements
- Each component fits to the next by means of a lapped joint that is sealed with butyl mastic tape. Surfaces must be clean and dry otherwise a good seal will not be formed
- With pre-formed cavity trays such as the System 2000 it is not strictly necessary for the cavity tray to span all the way across the cavity. As long as the cavity tray stands back from the rear face of the external wall and projects back into the cavity far enough to intercept drips falling from the wall ties, then it will perform effectively

Contact Timloc Technical department for installation guidance.

## How to order

- To calculate quantities divide the overall length of the cavity tray run by 830mm. If the calculation does not come to an exact figure, round up to the next whole number. The 410mm length can be used as a make up piece to reduce waste and cost
- If the cavity tray is required to turn a corner, ensure that the correct corner units are ordered
- Always order stopends - typical installations require one right hand and one left hand stopend for the start and finish of the run
- Always state the clear cavity width when ordering

## Bill of quantity

F30 Accessories/sundry items for brick/block/stone walling

Clause

370 PREFORMED CAVITY TRAY / ACCESSORIES

- Manufacturer: Timloc Building Products, Timloc House, Ozone Park, Howden, East Yorkshire, DN14 7SD. T: 01405 765567 W: www.timloc.co.uk
- Type(s) and location(s): Cavity tray supplied to be installed over horizontal abutments on new build applications, ring beam systems, airbricks, cavity liners, meter boxes, ducts etc.
- Build in carefully in accordance with manufacturer's recommendations to ensure a fully watertight installation.  
Reference: e.g. 2075/880 (830mm effective length)
- Optional Accessories: e.g. 2010 External Corner 90 Degree

For trays featuring the polystyrene strip mortar barrier insert 'P' at the end of the required product code. This may incur additional charge.



Timloc Building Products, Timloc House, Ozone Park, Howden, East Yorkshire, DN14 7SD  
T: 01405 765 567 E: sales@timloc.co.uk W: www.timloc.co.uk Technical | E: technical@timloc.co.uk