

ROOFLINE

by **timloc**

1m Over Fascia Vent

Efficient, durable ventilator in convenient 1m lengths

Use

- For roof eaves ventilation
- For flat roof abutment ventilation
- On roofs where the eaves incorporate a fascia board
- On roofs which do not incorporate a soffit board, or where an unbroken soffit board is required

Features and Benefits

- Efficient, very unobtrusive and easy to fit
- Superior strength construction - will carry the weight of the bottom row of tiles
- 3.5mm - 4mm wide ventilation slots comply with BS 5250 : 2011
- Durable and totally resistant to decay
- UV stabilised and colourfast
- Supplied in convenient 1m lengths

Quality

- Satisfies all NHBC requirements
- Manufactured to BS EN ISO 9001 and BS EN ISO 14001
- Complies with all relevant Building Regulations
- Meets all relevant British Standards

Material and Colour Choice

- Manufactured by injection moulding in polypropylene
- Available in black

Installation Advice

- Use OF1 to ventilate pitched roofs, where the pitch of the roof is 15° or more, and the roof void is attic or loft space
- Use OF2 to ventilate pitched roofs, where the pitch of the roof is less than 15°, flat roofs or any roof where living accommodation is contained within the roof space
- Make sure each ventilator is fixed securely into the top of the fascia board using screws or nails through each fixing hole provided
- On pitched roofs it is advisable to provide a felt support above the fascia ventilator. This will prevent the felt from sagging behind the fascia board and will maintain a clear air path at the front
- When ventilating flat roof abutments with OF2 some extra joinery work is essential - see the illustration above
- Ventilation must be provided for the full length of the eaves and along both sides of the building to create a cross flow ventilation action

How to Order

- Determine whether the roof design requires ventilation equivalent to a continuous 10mm opening (OF1) or 25mm opening (OF2)
- Measure the overall length of the eaves to be ventilated and divide by 1m to determine the number of ventilators required



Bill of Quantity

Over fascia ventilator 1000mm (10mm airflow)

G20 Carpentry/Timber Framing/First Fixing Clause

910^ EAVES SOFFIT VENTILATION

- Manufacturer: Timloc Building Products, Timloc House, Ozone Park, Howden, East Yorkshire, DN14 7SD. T: 01405 765567 W: www.timloc.co.uk
- Product Reference: OF1
- Type: Over Fascia Ventilator (1000mm) 10mm Airflow
- Colour: (Black)
- Airway: Provide the equivalent of a continuous opening of not less than 10mm for the full length of eaves.

Over fascia ventilator 1000mm (25mm airflow)

G20 Carpentry/Timber Framing/First Fixing Clause

910^ EAVES SOFFIT VENTILATION

- Manufacturer: Timloc Building Products, Timloc House, Ozone Park, Howden, East Yorkshire, DN14 7SD. T: 01405 765567 W: www.timloc.co.uk
- Product Reference: OF2
- Type: Over Fascia Ventilator (1000mm) 25mm Airflow
- Colour: (Black)
- Airway: Provide the equivalent of a continuous opening of not less than 25mm for the full length of eaves.

Product Codes

Free airflow	Length	Colour	Pack Quantity	Product Code
10,000mm ²	1m	Black	25	OF1BL
25,000mm ²	1m	Black	20	OF2BL

Product Dimensions

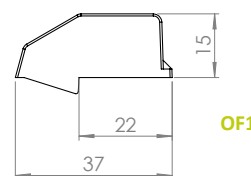

OF1

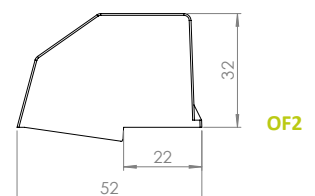

OF2