

INSULATION RETAINING DISCS

DATASHEET

A universal insulation retaining disc to suit most styles and sizes of wall tie

Use

- A universally designed insulation retaining disc.
- Suitable for general purpose, light duty and heavy duty applications.

Features & Benefits

- Will fit most wall ties available from leading wall tie manufacturers.
- Suitable for both fibre and rigid slab insulation.
- Firm grip design that will not move on the wall tie.

Quality

- Satisfies all NHBC requirements.
- Manufactured to BS EN ISO 9001 and BS EN ISO 14001.
- Complies with all relevant Building Regulations.
- Meets all relevant British Standards.

Material & Colour

- Manufactured from polypropylene.
- Available in Red or Black.

How to Order

- Typically, one disc per wall tie. Approximately 5 per square metre
- State the product code
- Supplied in pack quantities of:
 - 1000 - IRD80R
 - 1500 - IRD65BL

Product Codes

| Description | Colour | Diameter | Pack Quantity | Lead Time | Product Codes |
|---------------------------|--------|----------|---------------|------------------|---------------|
| Insulation Retaining Disc | Black | 65mm | 1500 | Next Working Day | IRD65BL |
| Insulation Retaining Disc | Red | 80mm | 1000 | Next Working Day | IRD80R |

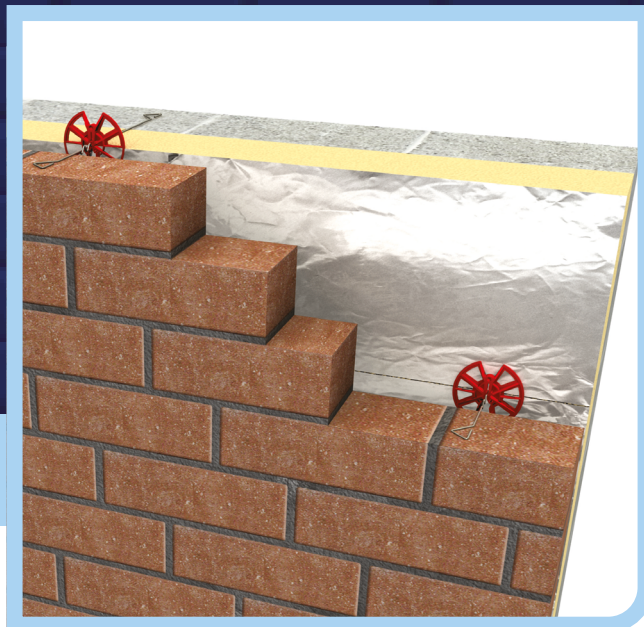

Environmental Product Declaration

A quantification of environmental information regarding the life cycle of the Insulation Retaining Discs. GWP total is for production stages A1-A3. Verified in accordance with ISO 14025. View the full EPD at timloc.co.uk.

| Product | EPD Reference | EPD Mass (KG) | GWP A1-A3 (KG CO2e) |
|---------|-------------------|---------------|---------------------|
| IRD65BL | EPD HUB, HUB-1836 | 0.005 | 1.25E-04 |
| IRD80R | EPD HUB, HUB-2180 | 0.0062 | 8.68E-03 |

Installation Advice

- Insulation retaining discs should be fitted to every wall tie for applications when insulation retainers are required
- Spacing and quantity calculations should be as wall tie guidance
- Consult latest NHBC Standards for required spacing
- 'Where partial cavity fill is to be used,' ties/discs should be spaced at 600mm centres horizontally and in vertical as well as horizontal rows, ie not staggered
- Retaining discs are clipped onto wall ties either before building in or in situ
- Due to the firm grip design the disc may require opening slightly to accept the wall tie
- It is recommended that the wall tie is held in position when the disc is offered and clipped in place