



# Adapt-Air DATASHEET

## Pre-assembled ducting to airbrick adapter set

### Use

- At floor level voids and external walls.
- Suitable for round and rectangular rigid extraction ductwork from:
  - Bathrooms
  - WC cloakrooms
  - Utility rooms
  - Kitchens

### Features & Benefits

- Enables rigid extraction ductwork termination to be built in as part of the brickwork package.
- Doesn't restrict or interrupt ducting airflow.
- Convenient '1 product code' assembled kits for immediate installation.
- Eliminates the requirement for retrospective through wall core drilling.
- Enables 1st fix ceiling & wall duct extraction and wall connections to outlet vent.
- Durable and totally resistant to decay.
- Airbricks available in Terracotta, Buff, Black, Brown, Grey, White and Blue Black.
- Suitable for working temperatures of -20 to 60°C.
- Allows for NHBC best practice recommendations.

### Quality

- Helping to meet Building Regulation Part F.
- Equivalent area marking to front face of airbrick to comply with BS EN 13141-1.
- Manufactured to BS EN ISO 9001.

### Material & Colour

- Airbrick manufactured from UV stabilised polypropylene.
- Available in Terracotta, Buff, Black, Brown, Grey, White, and Blue Black.
- All other components manufactured from PVC/PP.

### How to Order

- Quantity will be relative to the number of ventilation terminals required by the project.
- Ensure that the correct shaped set has been selected to suit the ductwork.
- State the airbrick colour required.

### Bill of Quantity

#### F30 Accessories/sundry items for brick/block/stone walling window jambs and sills

Clause 180 | CAVITY CLOSURES FOR CLOSING AROUND WINDOW & DOOR OPENINGS

- To extend not less than 150mm beyond ends of lintels/bridgings.
- Manufacturer: Timloc Building Products, Timloc House, Ozone Park, Howden, East Yorkshire, DN14 7SD. T: 01405 765567 W: [www.timloc.co.uk](http://www.timloc.co.uk)
- Reference: eg. CC2.4PPS/Multi100 (Thermo-loc Platinum Multi

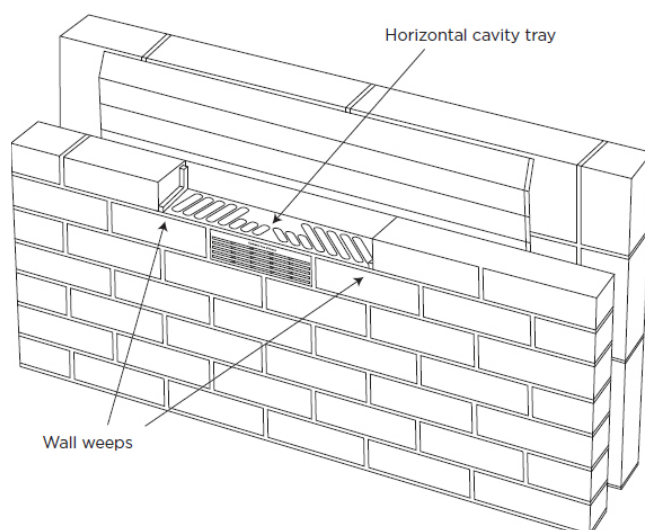
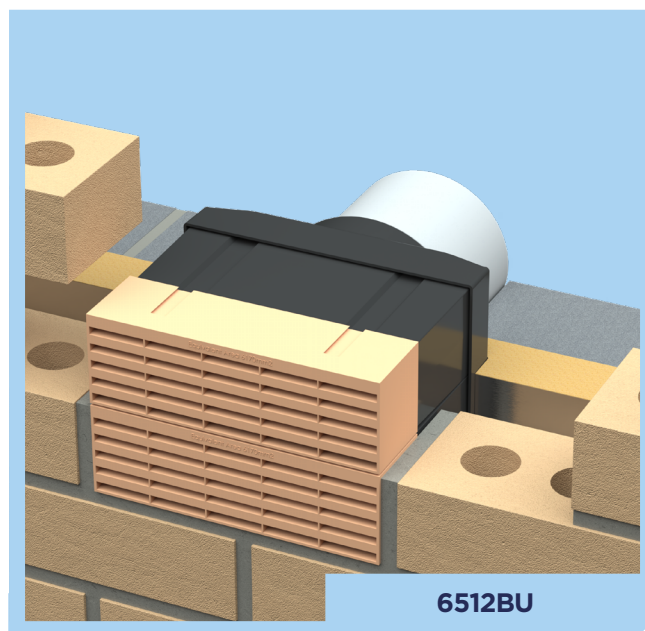
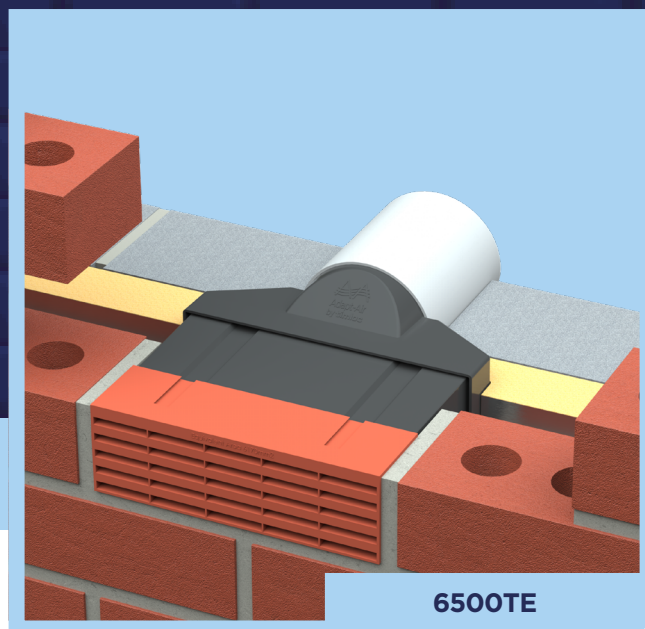

## Product Dimensions

**6512**  
**6525**  
**6515**  
**6550**

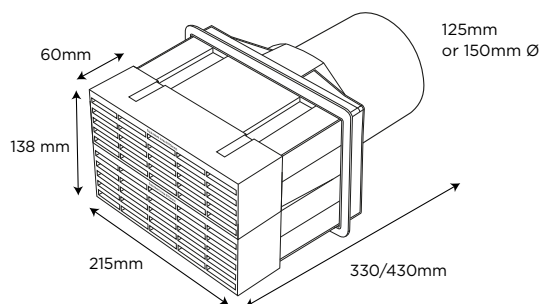

**6500**  
**6520**

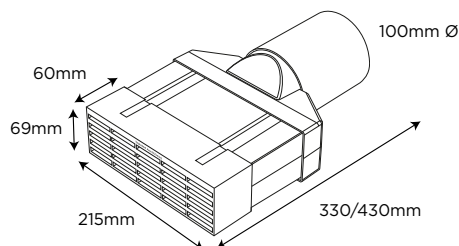

**6510**

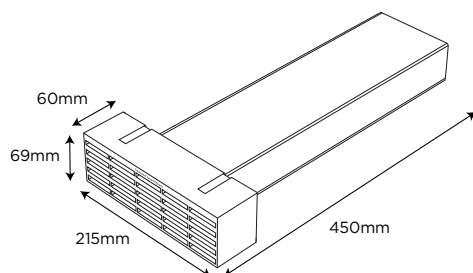

**3511**

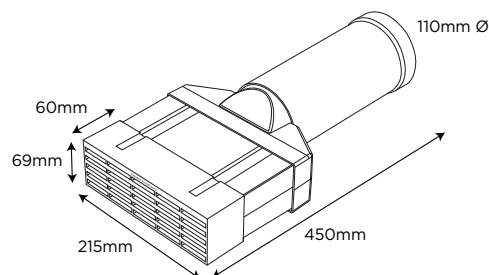

## Installation Advice

- Build in the set's airbrick (to replace a regular brick) as normal as brick and blockwork proceeds
- The installed position and level of the set is determined by the extraction fan connections
- The kit must be installed with a slight angle to the external leaf to allow for moisture drainage
- The set can be flush or project beyond the inner wall leaf to allow for the fitting of additional ducting or an extraction fan
- The cavity wall construction will determine most suitable option length kit required
- As with all through cavity wall components install a DPC cavity tray, with wall weep and stop ends, above the installed adapter set to collect any water ingress. We recommend the Inter-loc 4 horizontal cavity tray and 1143 or Invisiweep

## Product Codes

Product Code	Description	Duct Size	Overall Length	Box Qty	Lead Time
6500 + airbrick colour	Adapt-Air Single Airbrick 330mm x 100mm	100mm Ø	330mm	1	Next working day
6520 + airbrick colour	Adapt-Air Single Airbrick 430mm x 100mm	100mm Ø	430mm	1	Next working day
3511 + airbrick colour	Adapt-Air Single Airbrick 450mm x 110mm	110mm Ø	450mm	1	Next working day
6510 + airbrick colour	Adapt-Air Rectangular Single Airbrick 450mm x 100 x 54mm	100 x 54mm	450mm	1	Next working day
6512 + airbrick colour	Adapt-Air Double Airbrick 330mm x 125mm	125mm Ø	330mm	1	Next working day
6525 + airbrick colour	Adapt-Air Double Airbrick 430mm x 125mm	125mm Ø	430mm	1	Next working day
6515 + airbrick colour	Adapt-Air Double Airbrick 330mm x 150mm	150mm Ø	330mm	1	Next working day
6550 + airbrick colour	Adapt-Air Double Airbrick 430mm x 150mm	150mm Ø	430mm	1	Next working day

**State required colour at the end of the product code:** Terracotta: **TE**, Buff: **BU**, Grey: **GR**, Brown: **BR**, Black: **BL**, White: **WH**



# Adapt-Air

## 6500 | 6520 | 3511

Adapt-Air single airbrick

100mm diam tube (110mm adapter)

6500, 6520 & 3511 airflow		
m <sup>3</sup> /h	Pa	L/s
55	10	15.28
68	15	18.89
88	25	24.44
124	50	34.44
177	100	49.17

## 6510

Adapt-Air single airbrick

100mm diam tube 100mm x 54mm duct

6510 airflow		
m <sup>3</sup> /h	Pa	L/s
43	10	11.94
54	15	15.00
68	25	18.89
94	50	26.11
137	100	38.09

## 6512 | 6525

Adapt-Air double airbrick

125mm diam tube

6500, 6520 & 3511 airflow		
m <sup>3</sup> /h	Pa	L/s
123	10	34.00
155	15	43.06
195	25	54.17
279	50	77.50
396	100	110.00

## 6515 | 6550

Adapt-Air double airbrick

150mm diam tube

6515 & 6550 airflow		
m <sup>3</sup> /h	Pa	L/s
114	10	31.67
140	15	38.89
181	25	50.28
256	50	71.11
363	100	100.83

