

Cavity Trays for Door and Window Openings

Tailor-made cavity tray systems for all types of door/window arches and circular windows

Use

- Around the opening of an external door or window with an arched top or a circular external window
- On external walls - built from brick, block or stone as well as timber frame constructions - of any thickness and any cavity width

Features and Benefits

- One piece seamless mouldings eliminate the need for site fabrication to prevent errors through poor workmanship
- Tailor-made to order - manufactured to suit exact customer requirements with delivery to site usually within 10-14 working days
- Any size, type or radius of curve can be fabricated
- Can be supplied in two or more sections to allow adjustment on site and easily compensate for building tolerances
- Easy to handle, flexible, tough, durable and puncture resistant
- Fully compatible with all Timloc DPC and cavity tray systems
- Can be used for multi-storey or high loading applications - will not extrude under loads up to the point of compressive failure of wall
- Wide range of standard components with special, tailor-made accessories also readily available

Quality

- Satisfies all NHBC requirements
- Manufactured to BS EN ISO 9001 and BS EN ISO 14001
- Complies with all relevant Building Regulations
- Meets all relevant British Standards

Material and Colour Choice

- All products are vacuum formed in 2.0mm thick medium density polyethylene
- Available in black only

Installation Advice

- Under normal circumstances the arch and bullseye cavity tray is positioned so that the upstand fits between the door/window frame and the external brickwork. After installation the upstand can be trimmed back flush with the frame and sealed with exterior mastic in the normal way
- Weep holes must be provided at the base of the arch cavity tray at both sides of the opening. These can be formed by installing a purpose made Timloc plastic wall weep unit (product 1143/Invisiweep)
- When the arch and bullseye cavity tray is supplied in two or more sections, each section fits to the next by means of a lapped joint that is sealed with butyl mastic tape. Surfaces must be clean and dry otherwise a good seal will not be formed
- Arch and bullseye cavity trays are usually supplied with an integral flap which builds in to the inner leaf to ensure it is held securely in position. If building-in is not possible. e.g. with a timber frame construction, the cavity tray flap should be mechanically fixed to the inner leaf.

Contact Timloc Technical department for installation guidance.

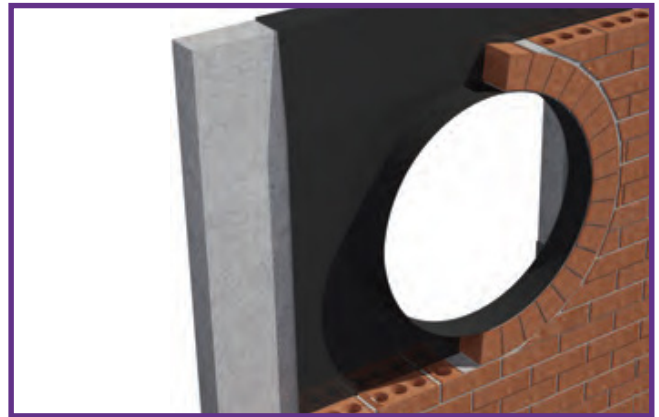
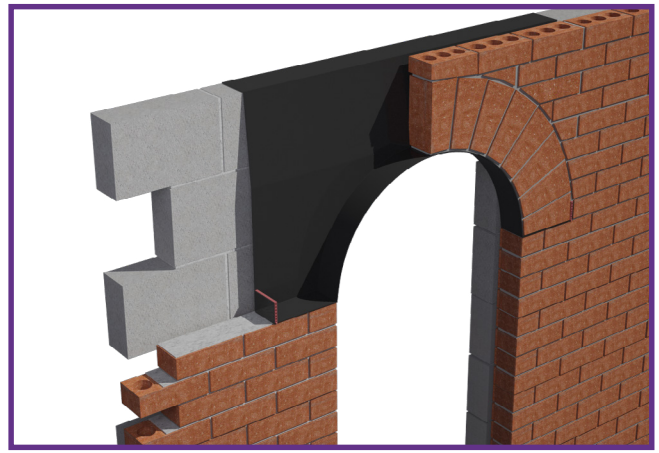

How to Order

Arch cavity trays are made to order, so please supply full construction details. Ideally these will include a fully dimensioned drawing showing door/window opening size and wall construction details. If this is not possible the minimum information required is:

- Thickness of outer leaf and cavity width
- Clear opening width and height of door/window opening
- Radius of curvature
- Position of spring line
- With this data Timloc will be able to produce and despatch a dimensioned drawing for your approval.

Bill of Quantity

F30 Accessories/sundry items for brick/block/stone walling
Clause

385 | PREFORMED DPC / CAVITY TRAY JUNCTION CLOAKS / STOPENDS

- Manufacturer: Timloc Building Products, Timloc House, Ozone Park, Howden, East Yorkshire, DN14 7SD. T: 01405 765567, W: www.timloc.co.uk
- Type(s) and location(s): Preformed Arch Cavity Tray to be positioned directly over external arch window features/lintels.
- Seal all laps with dpc and/or cavity trays using adhesive/mastic in accordance with manufacturers recommendations to ensure a fully watertight installation.
- Reference: SPA Arch Dpc Cavity Tray
- Diameter: Types & sizes as shown on drawings/window schedule.

Bill of Quantity

F30 Accessories/sundry items for brick/block/stone walling
Clause

385 | PREFORMED DPC / CAVITY TRAY JUNCTION CLOAKS / STOPENDS

- Manufacturer: Timloc Building Products, Timloc House, Ozone Park, Howden, East Yorkshire, DN14 7SD. T: 01405 765567, W: www.timloc.co.uk
- Type(s) and location(s): Preformed Circular Cavity Tray to be positioned directly around external circular window features/lintels.
- Seal all laps with dpc and/or cavity trays using adhesive/mastic in accordance with manufacturers recommendations to ensure a fully watertight installation.
- Reference: SPB Bullseye Dpc Cavity Tray
- Diameter: Types & sizes as shown on drawings/window schedule.