



## Adapt-Air

Simple to install pre-assembled sets, which quickly and conveniently adapts extraction ductwork to terminate at a standard plastic airbrick.

### Use

At:

- Floor level voids
- External walls

Suitable for round and rectangular rigid extraction ductwork from:

- Bathrooms
- WC cloakrooms
- Utility rooms
- Kitchens

### Features and benefits

- Enables rigid extraction ductwork termination to be built in as part of the brickwork package
- Doesn't restrict or interrupt ducting airflow
- Convenient '1 product code' assembled kits for immediate installation
- Eliminates the requirement for retrospective through wall core drilling
- Enables 1st fix ceiling & wall duct extraction and wall connections to outlet vent
- Durable and totally resistant to decay
- Airbricks available in terracotta and buff to blend with various brick types (other colours available on request)
- Suitable for working temperatures of -20 to 60°C

### Quality

- Helping to meet Building Regulation Part F
- Equivalent area marking to front face of airbrick to comply with BS EN 13141-1
- Manufactured to BS EN ISO 9001

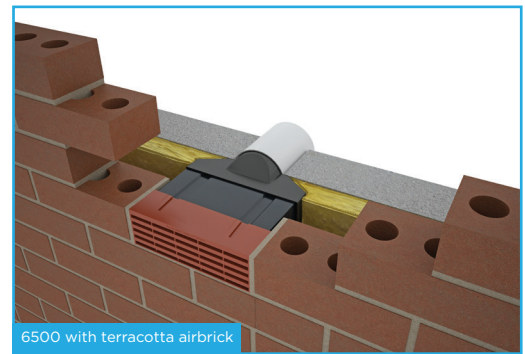

6500 with terracotta airbrick

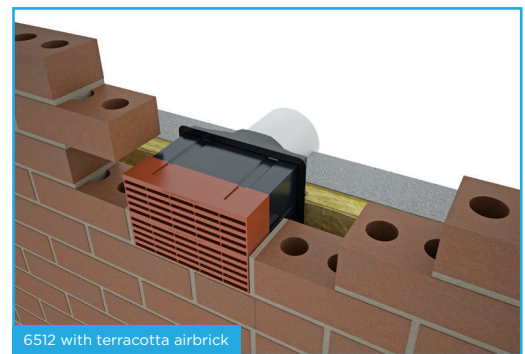

6512 with terracotta airbrick

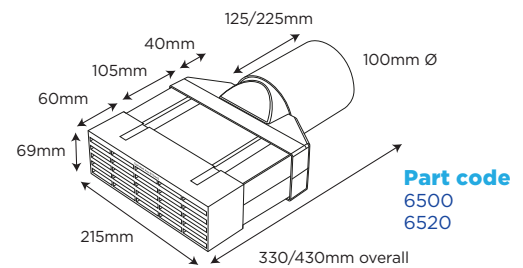

**Part code**  
6500  
6520

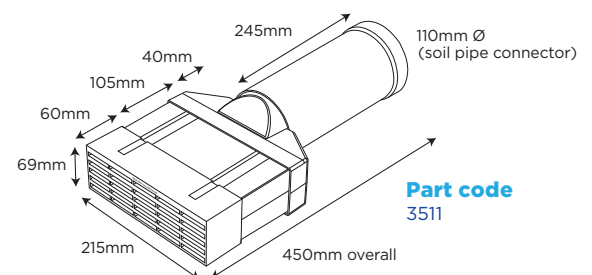

**Part code**  
3511

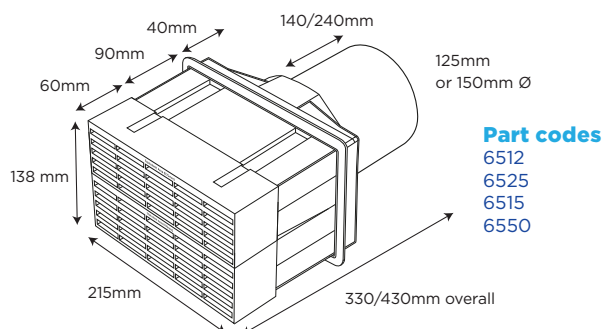

**Part codes**  
6512  
6525  
6515  
6550

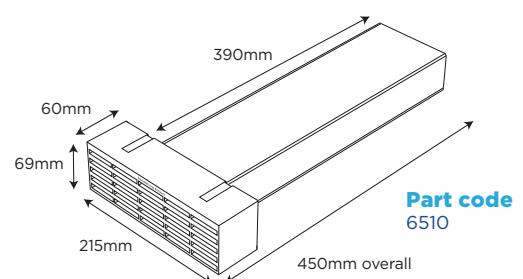

**Part code**  
6510



# Adapt-Air Ducting to airbrick adapter sets

Simple to install pre-assembled sets, which quickly and conveniently adapts extraction ductwork to terminate at a standard plastic airbrick.

## Material and colour choice

- Airbrick manufactured from UV stabilised polypropylene
- Available in terracotta and buff
- All other components manufactured from PVC/PP

## Installation advice

- Build in the set's airbrick (to replace a regular brick) as normal
- as brick and blockwork proceeds
- The installed position and level of the set is determined by the extraction fan connections
- The set can be flush or project beyond the inner wall leaf to allow for the fitting of additional ducting or an extraction fan
- The cavity wall construction will determine most suitable option length kit required
- As with all through cavity wall components install a DPC cavity tray, with wall weep and stop ends, above the installed adapter set to collect any water ingress. - We recommend the Inter-loc 4 horizontal cavity tray and 1143 or InvisiWeep, the almost invisible wall weep
- Timber/Steel frame wall construction may require cavity barriers or intumescent collars

## How to order:

- Quantity will be relative to the number of extraction fans required by the project
- Ensure that the correct shaped set has been selected to suit the ductwork
- State the airbrick colour required

## Product codes

Description	Duct size	Tube length	Product codes
Adapt-Air Single Airbrick 330mm x 100mm round	100mm Ø	330mm	6500 + airbrick colour
Adapt-Air Single Airbrick 430mm x 100mm round	100mm Ø	430mm	6520 + airbrick colour
Adapt-Air Single Airbrick 450mm x 110mm round	110mm Ø	450mm	3511 + airbrick colour
Adapt-Air Rectangular Single Airbrick 450mm x 100 x 54mm rectangle	100mm x 54mm	450mm	6510 + airbrick colour
Adapt-Air Double Airbrick 330mm x 125mm round	125mm Ø	330mm	6512 + airbrick colour
Adapt-Air Double Airbrick 430mm x 125mm round	125mm Ø	430mm	6525 + airbrick colour
Adapt-Air Double Airbrick 330mm x 150mm round	150mm Ø	330mm	6515 + airbrick colour
Adapt-Air Double Airbrick 430mm x 150mm round	150mm Ø	430mm	6550 + airbrick colour
Adapt-Air Extended Tube 500mm x 100mm round	100mm Ø	500mm	3505

State required colour at the end of the product code: TE: Terracotta, BU: Buff. (1-2 working days)  
Other colours available on request (2-3 days)

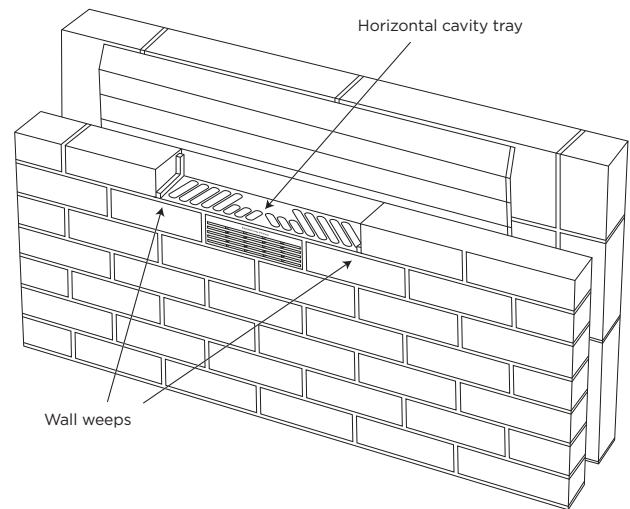



# 6500, 6520 & 3511 ADAPT-AIR single airbrick

100mm diam tube (110mm adaptor)

6500, 6520 & 3511 airflow

m3/h	Pa	L/s
55	10	15.28
68	15	18.89
88	25	24.44
124	50	34.44
177	100	49.17

6500, 6520 & 3511 vent airflow volume

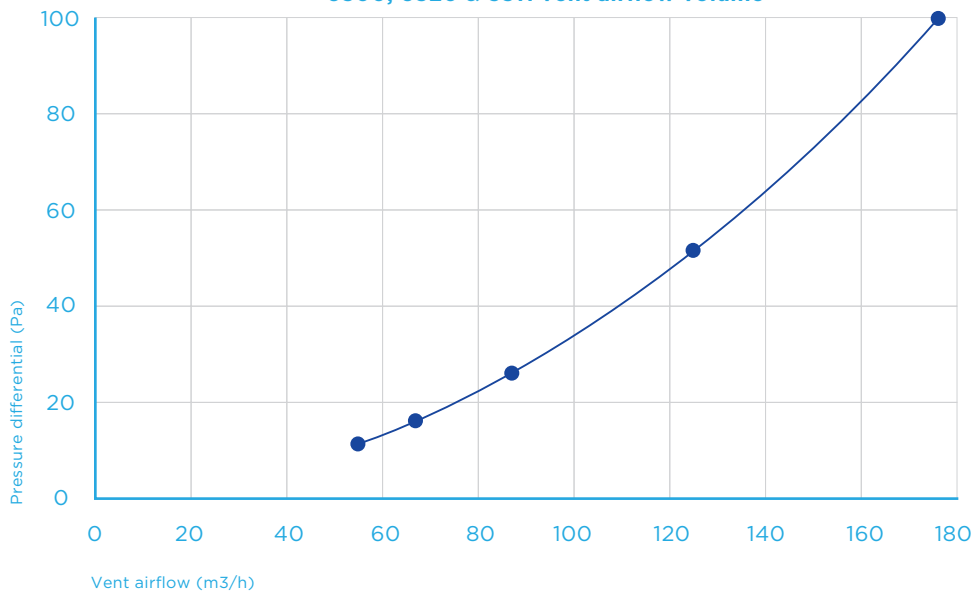

# 6510 ADAPT-AIR single airbrick

100mm x 54mm duct

6510 airflow

m3/h	Pa	L/s
43	10	11.94
54	15	15.00
68	25	18.89
94	50	26.11
137	100	38.06

6510 vent airflow volume

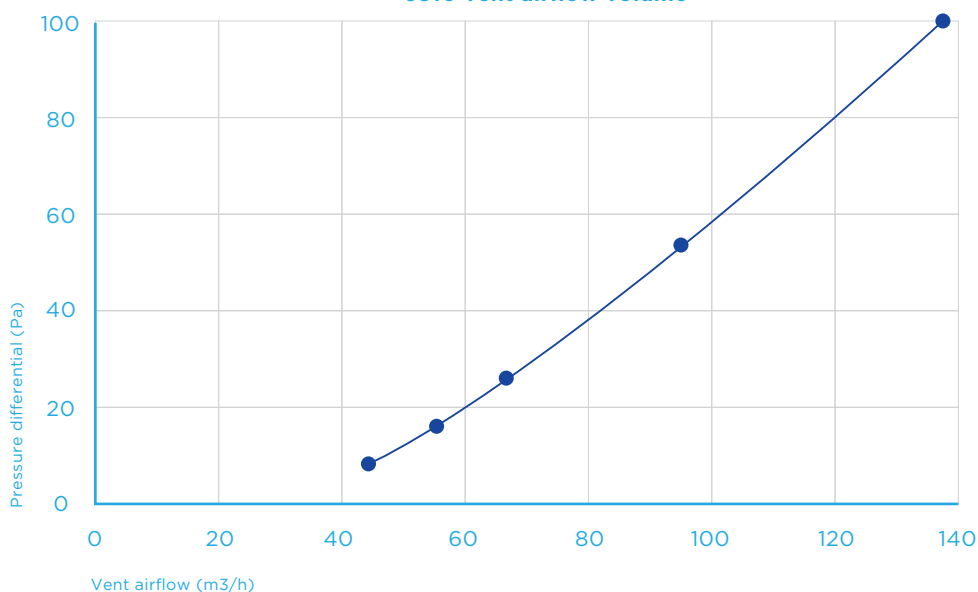



# 6512 & 6525 ADAPT-AIR double airbrick

125mm diam tube

6512 & 6525 airflow

m <sup>3</sup> /h	Pa	L/s
123	10	34.00
155	15	43.06
195	25	54.17
279	50	77.50
396	100	110.00

6512 & 6525 vent airflow volume

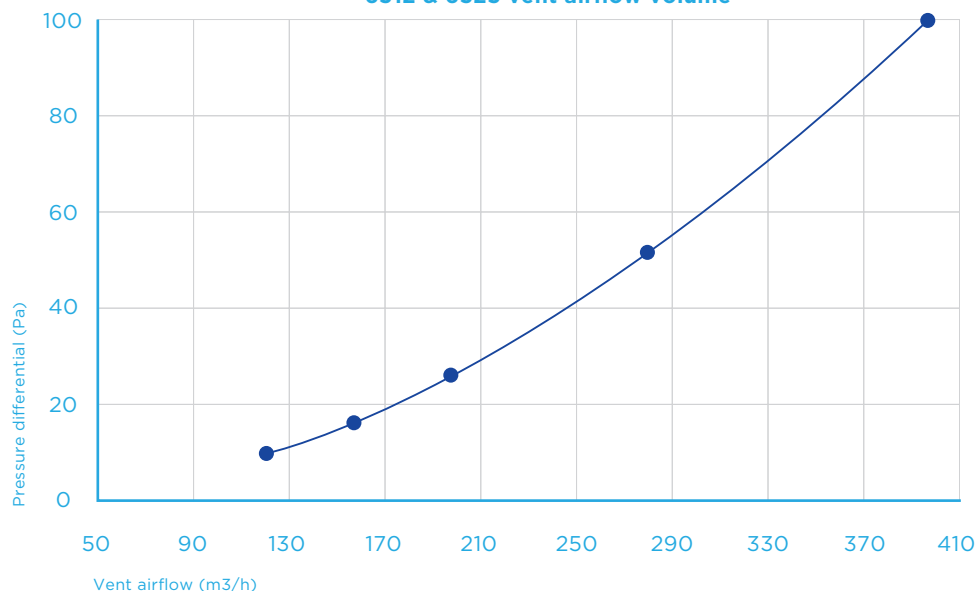

# 6515 & 6550 ADAPT-AIR double airbrick

150mm diam tube

6515 & 6550 airflow

m <sup>3</sup> /h	Pa	L/s
114	10	31.67
140	15	38.89
181	25	50.28
256	50	71.11
363	100	100.83

6515 & 6550 vent airflow volume

